



# Other duties as assigned:

the perils and the possibilities  
of a  
major classroom building renovation

**CLAC 2013**

James Uhrich, AVP and CTO  
Marsha Schnirring, AVP and STO  
**Occidental College**, Los Angeles, CA



project, perils, possibilities

your turn

time to share, Q+A

# THE PROJECT

- 1 historic building
- 1 architect
- 1 auditorium
- 1 media wall
- 1 media partner
- 13 learning environments
- 15 months
- 50+ offices
- 100+ different perspectives









# THE MCKINNON FAMILY CENTER FOR GLOBAL AFFAIRS

Given by  
Ian and Sonnet McKinnon

**Belzberg Architects**  
2919 1/2 Main St  
Santa Monica, CA



**Hagy  
Belzberg**

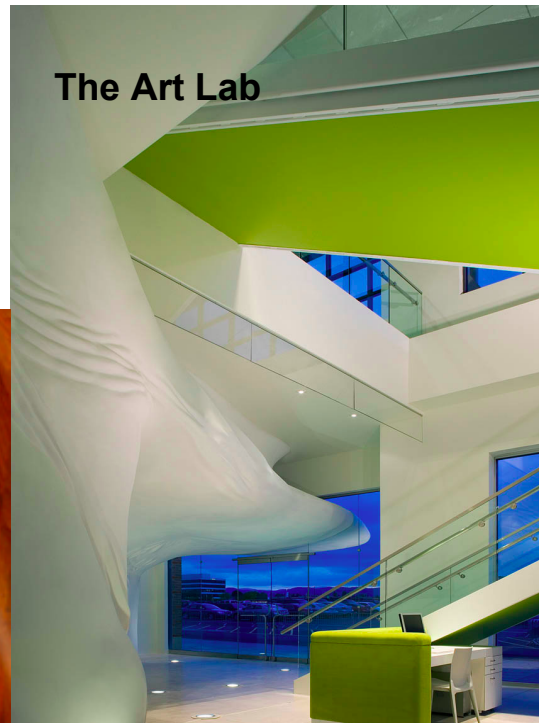

**The Art Lab**

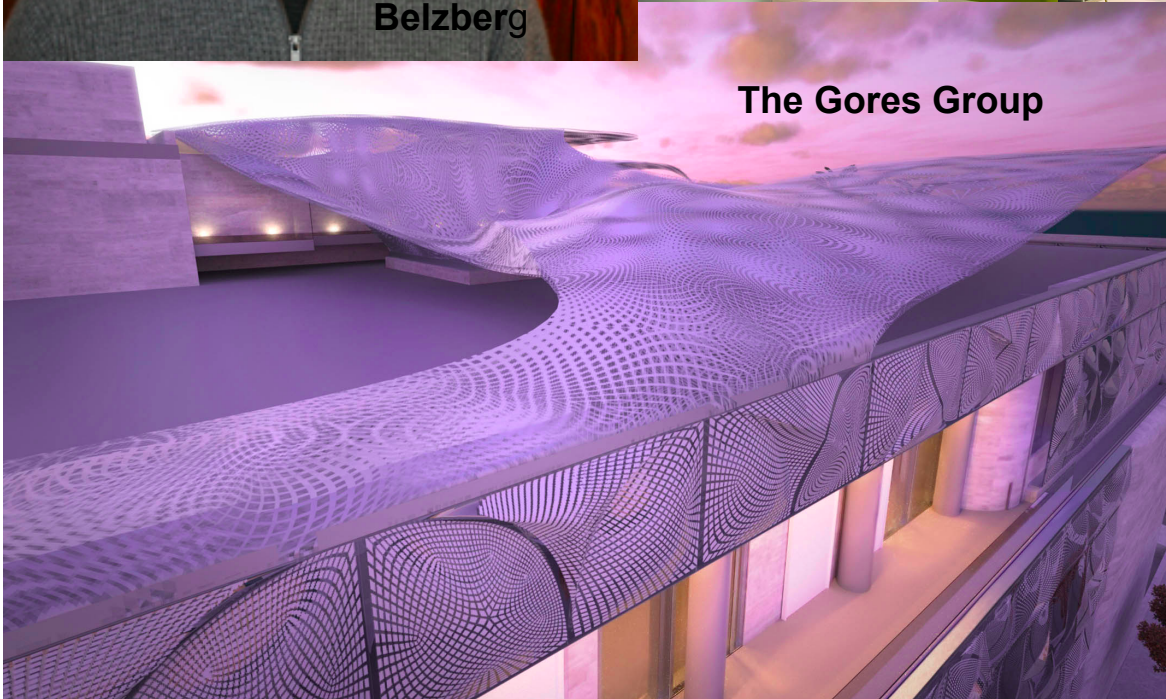

**The Gores Group**



**LA Museum of  
the Holocaust**



采荷堂

THE CHOI AUDITORIUM



采荷堂

THE CHOI AUDITORIUM





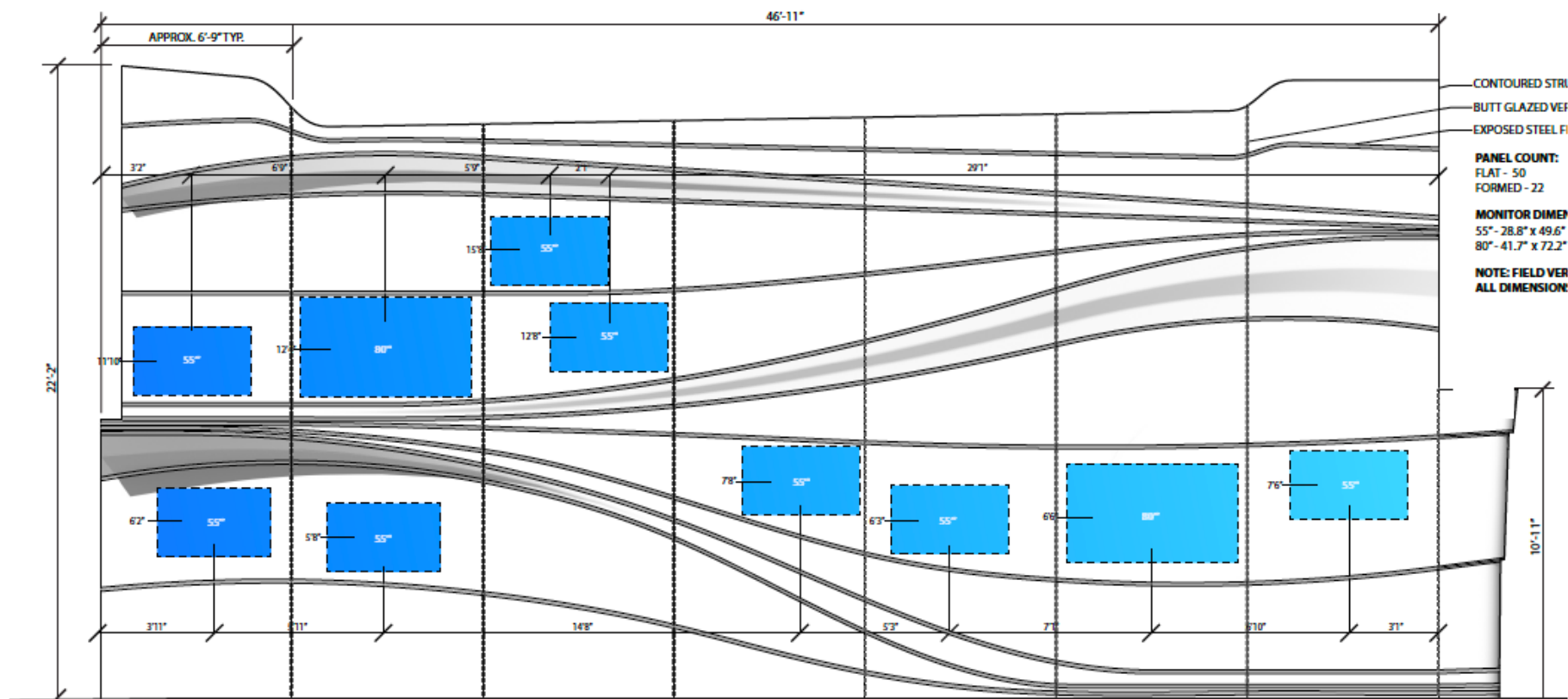

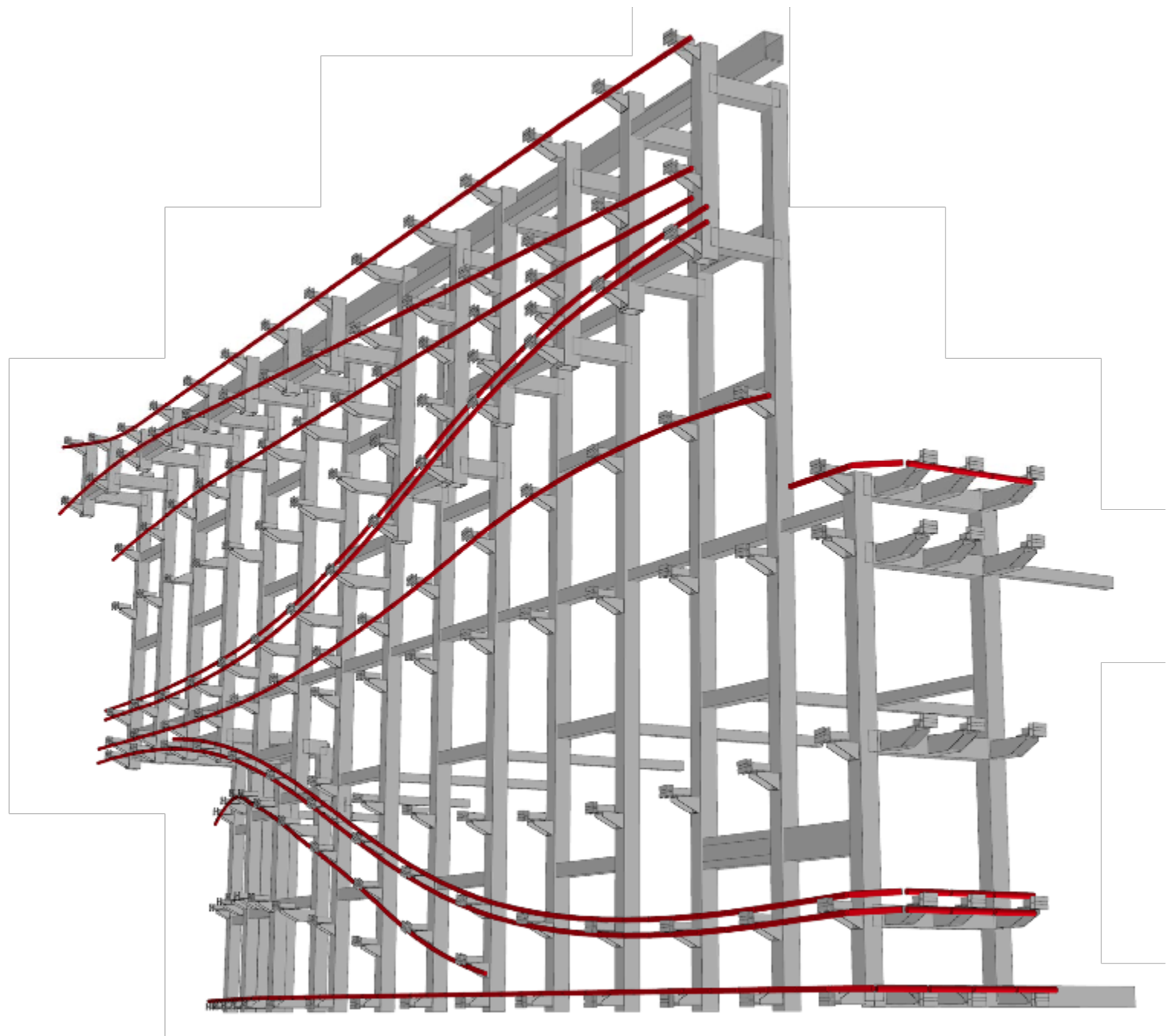





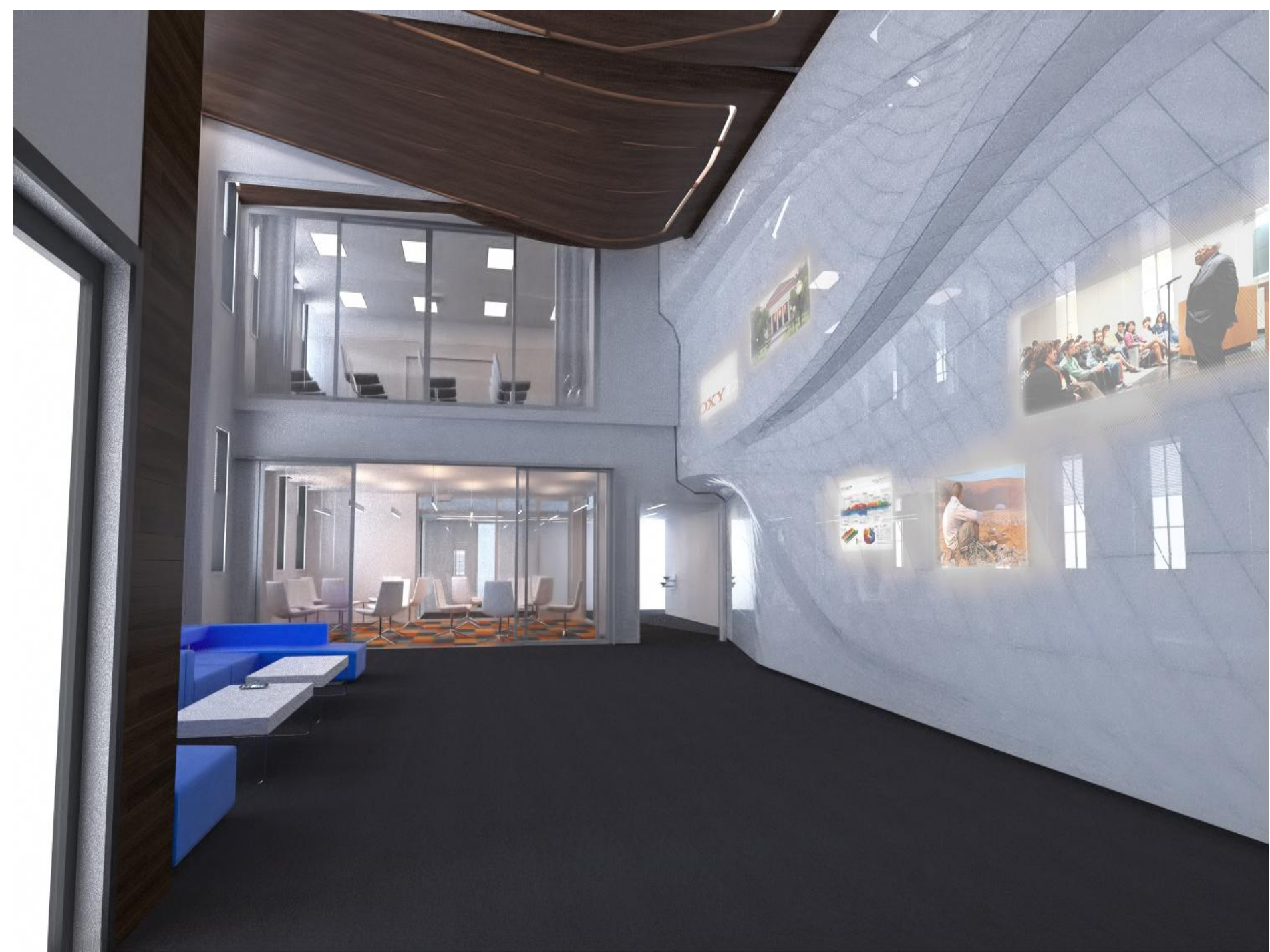



OXY12

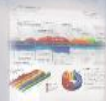

McKinnon Family  
Center for Global Affairs



*Second Story is an innovation center pioneering new interactive experiences. We push the boundaries of storytelling*







# OXY GLOBAL CROSSROADS

Occidental College's Global Crossroads will create an atmosphere to foster ideation and conversation.

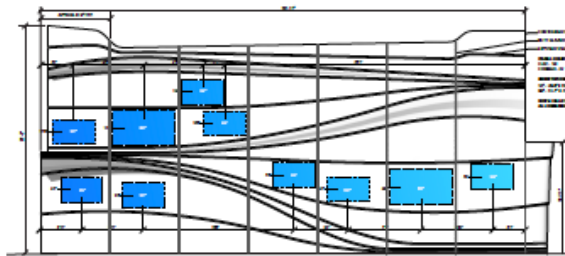

Media Wall



Web App

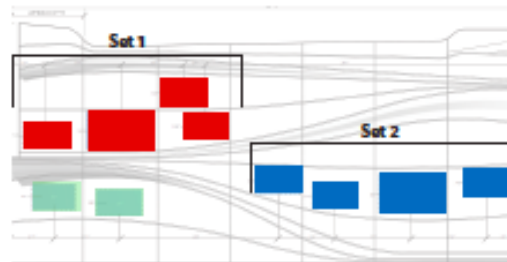

#### EXAMPLE OF A DAY SCHEDULE

	Set 1	Set 2
5AM	Projects - Resource Only: Java & Feeds	Projects - Resource Only: Java & Feeds
6AM		
7AM	Event & Course	Event & Course
8AM	Map of Projects	Projects - Linear: H2 Oxy
9AM	Highlight Projects: Power Lunch	
10AM		
11AM	Projects - Resource Only: Class Struggle	
Noon		
1PM		
2PM	Highlight Projects: Globetrotters	Projects: Hot Spots
3PM		Map of Dispatches
4PM	Projects - Resource Only: Class Struggle	
5PM		
6PM	Project: ShoutOuts	Projects - Resource Only: Community Interaction
7PM	Projects - Resource Only: Cutting Edge	
8PM		Projects - Resource Only: Vox Populi
9PM	Feed: Hash Tag	
10PM	Projects - Resource Only: In Medias Res	
11PM		

DAY SCHEDULE	DAY SCHEDULE
--------------	--------------

#### EXAMPLE OF A TAKE OVER

Set 1	Set 2
Event Info & Imagery	
Two Main Screens: Live Event	
Event Info & Imagery	



**LPA**

Section 5  
Classroom Design Alternatives

OCCIDENTAL COLLEGE  
Johnson Hall Classroom Design

#### First Floor Classrooms

The following outlines the size and number of students each classroom can accommodate:

Classroom	SF	Students
• 103	590 SF	25-30
• 104	577 SF	25-30
• 105	558 SF	20-28



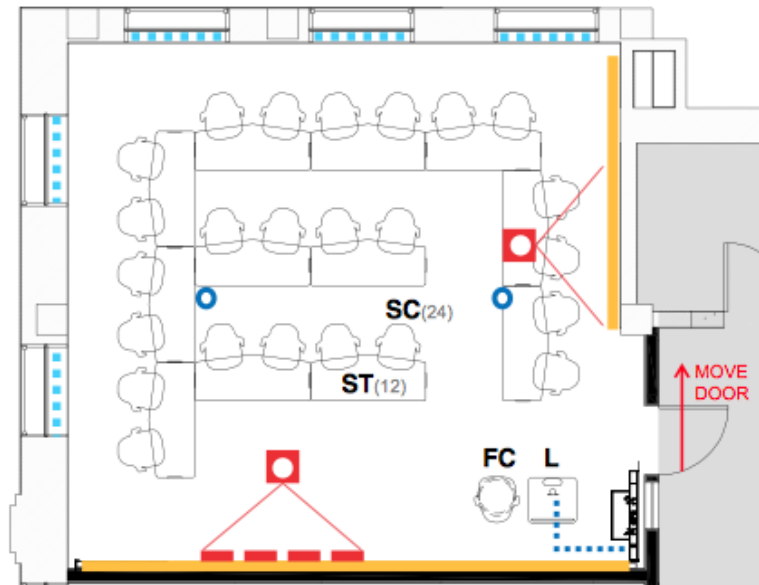

LPA

Section 5  
Classroom Design Alternatives  
OCCIDENTAL COLLEGE  
Johnson Hall Classroom Design

#### Legend:

Window Shade

Whiteboard

Fiat Screen Monitor

Projection Screen

Ceiling Mounted Projector

Quad Floor Power Receptacle

Floor AV and Data Receptacles

Lectern tethered to AV, Data & Power in Wall

Lectern, see section 3

FC Faculty Chair, see section 3

SC Student Chair, see section 3

ST Student Table, see section 3

#### Considerations:

- **CAPACITY 24 [20-28 requested]**
- Horseshoe | Lecture | Discussion
- $\pm 36"$  of Circulation about perimeter
- The second projection is a priority





# THE VARELAS INNOVATION LAB

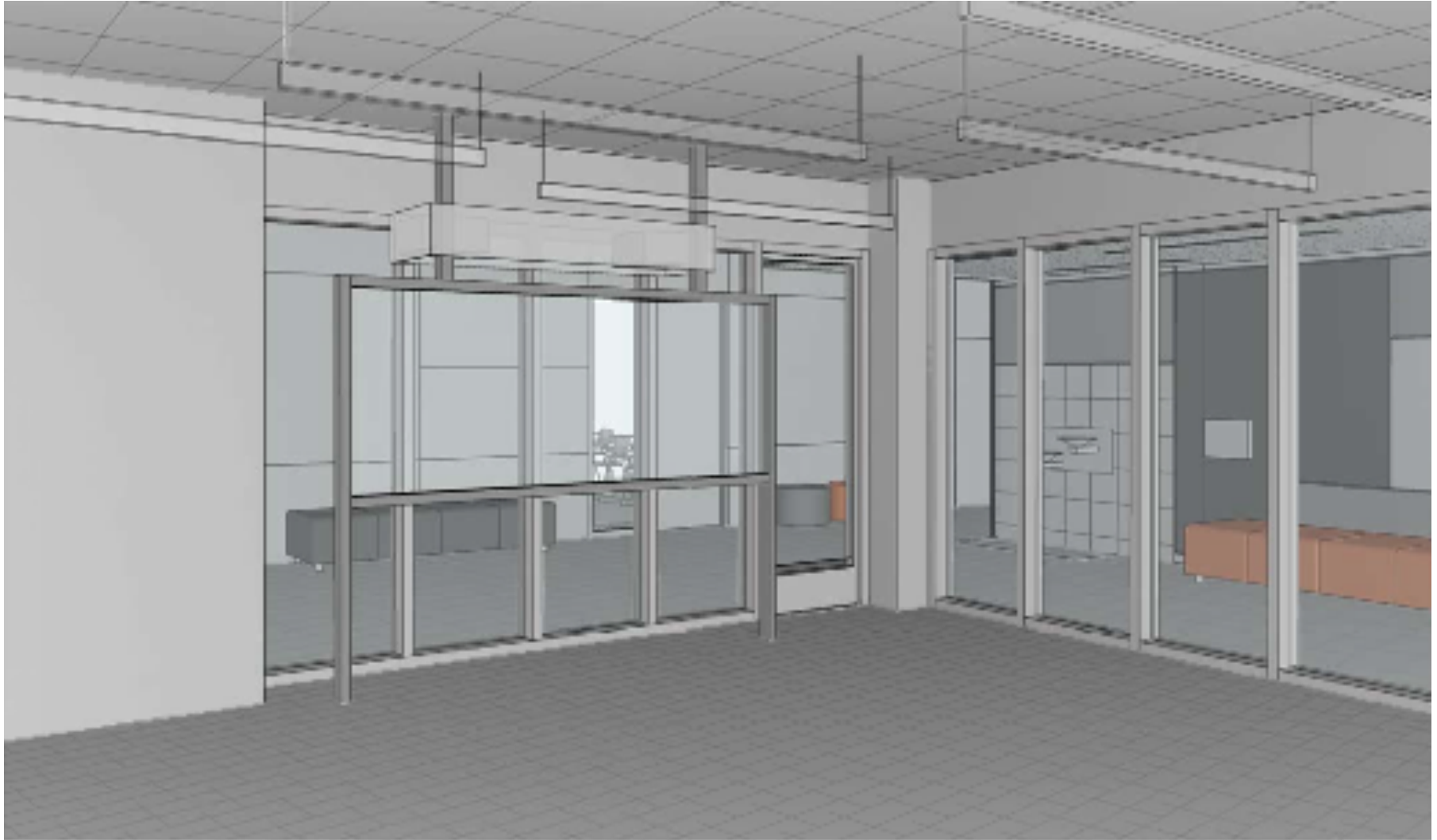

# THE VARELAS INNOVATION LAB

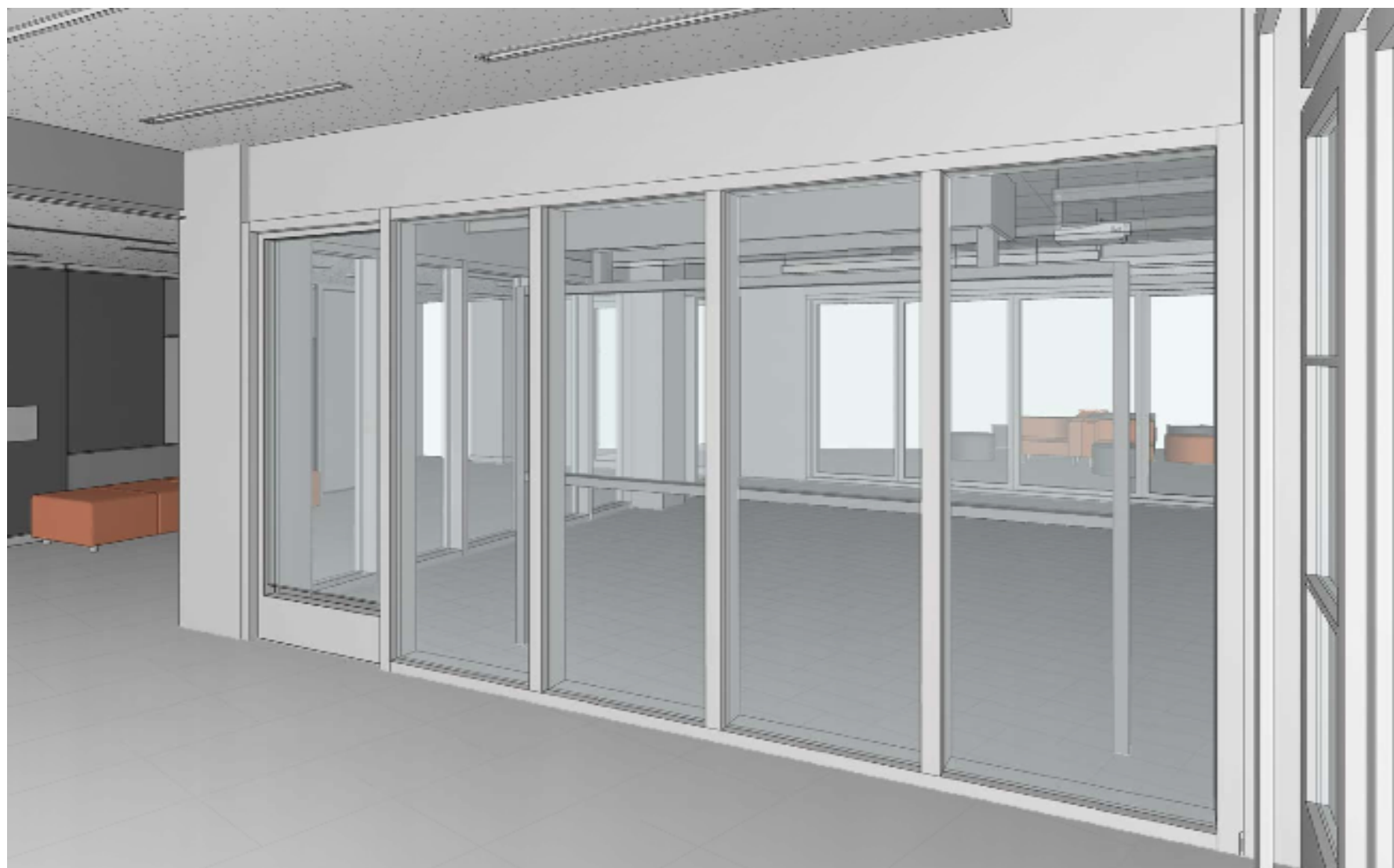



# THE PERILS

managing expectations  
solves all problems  
meets all needs  
late-comers to the party  
IR  
faculty participation  
scope creep/change



# THE POSSIBILITIES



innovative teaching & learning

learning spaces palette(s)

tech infrastructure

collaborations / relationships

expanded opportunities for professional staff

# YOUR TURN



your own  $P^3$  stories

no story of your own? make up one!

# SHARE

tell us

Q+A



**CLAC 2013**

# THANK ...



# YOU!

come see us @ the XRDS

**CLAC 2013**